

# Quick Install Guide for LMU-1200 and LMU-2631 on Generators

Pin	Signal	Description	Color	I/O	Use
1	GND	Ground	<b>Black</b> (22 AWG)	Ground	Asset ground (battery ground)
2	OUT-0	Starter disable relay driver	<b>Green</b> (22 AWG)	Output	
3	IN-1	Digital input	<b>Blue</b> (22 AWG)	Input	
4	TXD	Host TxD	<b>Blue</b> (22 AWG)	Input	
5	ADC-1	Analog to digital input 1	<b>Pink</b> (22 AWG)	Input	Fuel gauge
6	IN-3	Digital input	<b>Violet</b> (22 AWG)	Input	
7	OUT-3	Digital output (open collector)	<b>Grey</b> (22 AWG)	Output	
8	IN-0	Ignition	<b>White</b> (20 AWG)	Input	Asset ignition
9	VDD	VDD reference output (20-25mA max)	<b>Orange</b> (22 AWG)	Output	
10	OUT-1	Digital output (open collector)	<b>Brown</b> (22 AWG)	Output	
11	OUT-2	Digital output (open collector)	<b>Yellow</b> (22 AWG)	Output	
12	IN-2	Digital input	<b>Orange</b> (22 AWG)	Input	
13	RxD	Host RxD	<b>Green</b> (22 AWG)	Output	
14	VCC	Primary power input	<b>Red</b> (20 AWG)	Power	Asset power (battery post)
15	GND	Primary ground	<b>Black</b> (20 AWG)	Ground	
16	GND	Backup battery ground	<b>Black</b> (22 AWG)	Ground	
17	Not connected				
18	Not connected				
19	GND	Ground		Ground	
20	Not connected				

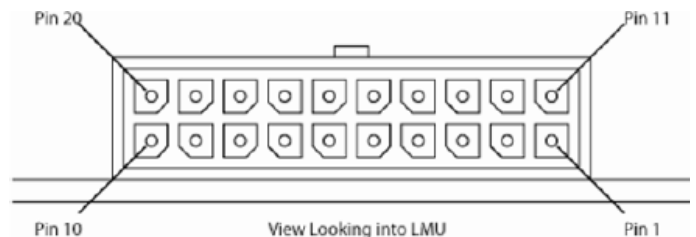

## Smart Cable Wiring

### For Isuzu, Airman SDG 45S, and Airman SDG 65S Generators

1. 20-pin LMU connector
2. Ignition
3. Ground at battery post
4. Power at battery post
5. Power at battery post
6. 16-pin ECM connector
7. Pink wire (connects to fuel sending unit)

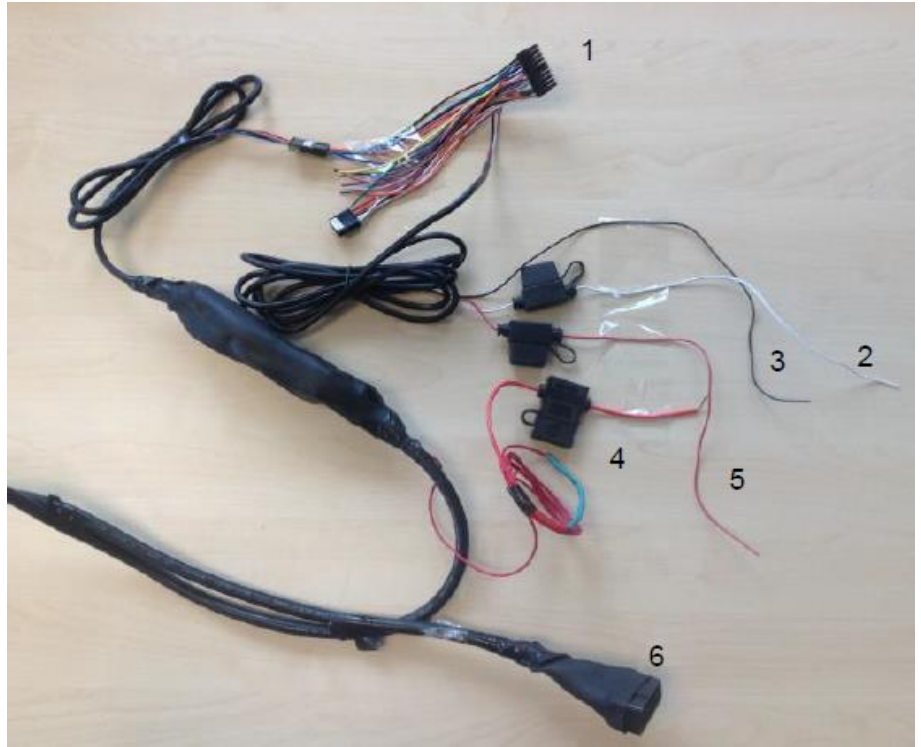

### For Kubota Generators

1. 20-pin LMU connector
2. Ignition
3. Ground at battery post
4. Power at battery post
5. Power at battery post
6. Kubota Y-connector
7. Pink wire (connects to fuel sending unit)

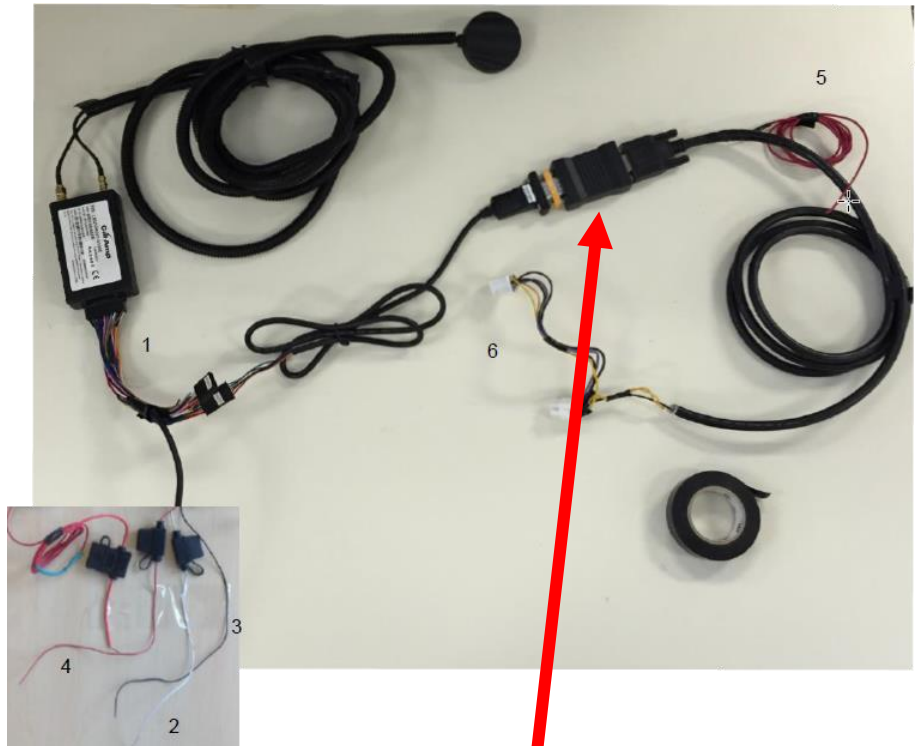

## For Cummins Generators

1. 20-pin LMU connector
2. Ignition
3. Ground at battery post
4. Power at battery post
5. Power at battery post
6. 9-pin Deutsche connector
7. Pink wire (connects to fuel sending unit)



## Fuel Sending Unit Wiring

Locate the sender wire from the fuel gauge going to the sending unit and then connect it to the main harness pink wire (pin 5)

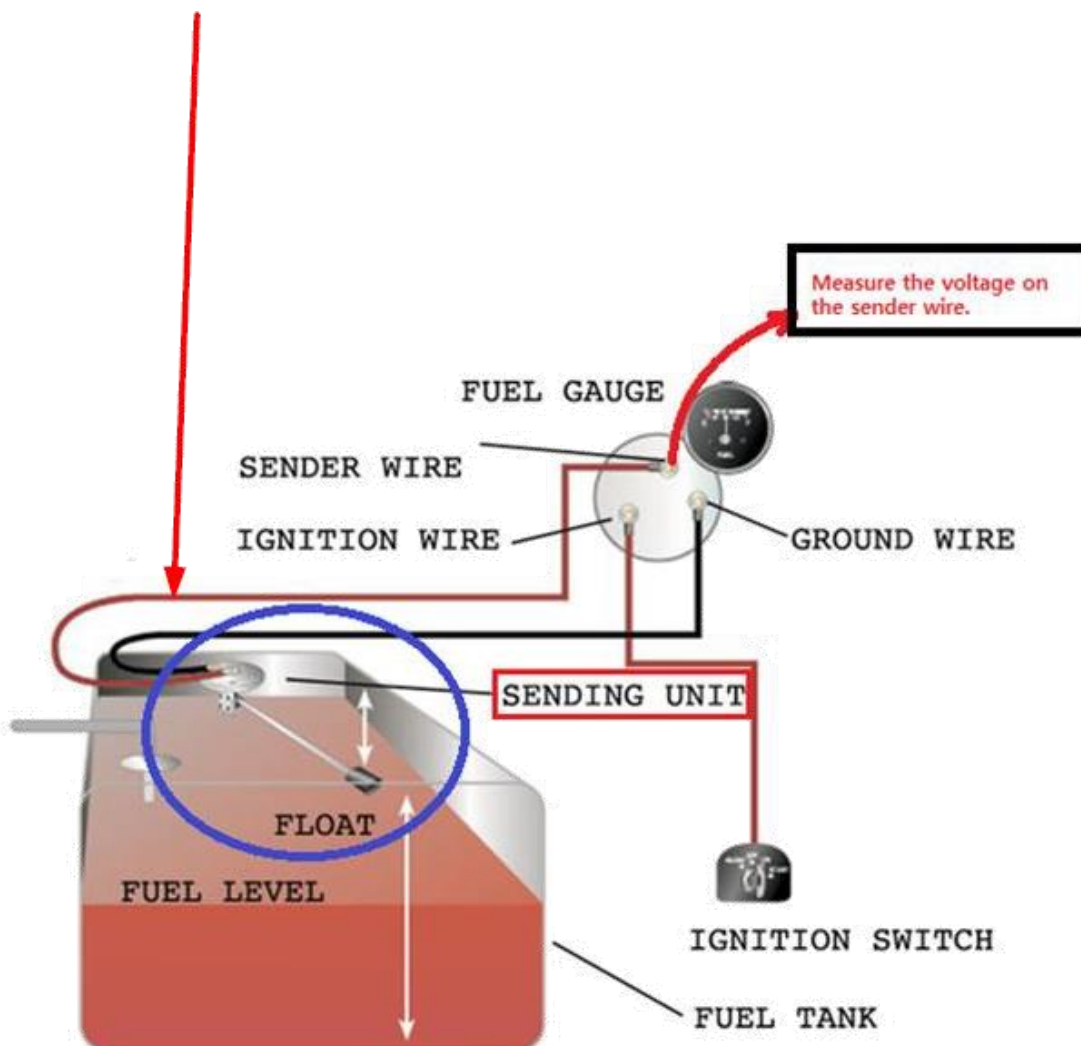

## Basic Installation Steps

1. Mounting considerations for the tracking unit:
  - It must be mounted in an unexposed and dry location, ideally under the generator panel/hood.
  - It must be mounted to a solid part of the generator, either the chassis or any other solid surface that will not move or vibrate during normal usage. This ensures that the unit remains secure.
2. Mounting considerations for the internal GPS antenna:
  - It must be mounted in full view of the sky with the beveled side facing skyward.
  - **DO NOT** mount the antenna where it is obstructed by metal or electrical/RF interference.
  - Secure the antenna in place with double-sided tape or similar so it does not vibrate or move.
3. Mounting considerations for the internal cellular antenna:
  - It must be mounted as vertically as possible.
  - Ideally, it must be mounted at least one inch away from any metal.
4. Identify the following wires on the wiring harness:
  - Ground (**black**)
  - Constant power (**red**)
  - True ignition (**white**)
5. Connect **ground** to the battery post using a ring terminal. Avoid extending this wire.
6. Connect **power** to +12V battery post using a ring terminal. Make sure the fuse is in-line.
7. Connect **ignition** to true +12V ignition using a ring terminal at the ignition switch. Make sure the fuse is in-line.  
**NOTE:** Make sure this is true ignition and **not** the accessory wire!
8. Make the following connections:
  - Connect the ECM cable to the generator's OBD-II.
  - Connect the loose **red** wire to constant 12V.
  - Connect the 5-pin Molex connector to AUX1 (**not** AUX2).
9. (Optional) Once you have made the 3 connections described above, you may turn the asset ignition on (without starting it) so that the device can establish a network connection while you complete the installation. This helps the install check process (step 13).
10. Position the GPS antenna and then insert the Molex connector to the LMU.
11. Tie up remaining unused wiring and secure the hardware under the panel using zip ties or screws.
12. Ensure the generator is in an outdoor area with a clear view of the sky. Turn on the generator and wait 1-2 minutes for the LEDs on the LMU to illuminate.
  - If the install was successful, the **green** LED (GPS) and **amber** LED (network) will be illuminated (solid, not flashing).
13. Perform an install check by calling the BSM Support Team at 1-888-776-3333
14. Complete the installation worksheet and then email it to [customercare@bsmtechnologies.com](mailto:customercare@bsmtechnologies.com)